

Dold World Journeys Presents

Mekong River Cruise - Ship Details

Avalon Saigon - Built in 2018 • 195 ft. long • 18 Staterooms • up to 36 Guests • 24 Crew Members

Room Features:

- Alarm clock
- Bedside tables with reading lamps
- Comfort Collection Beds
- Individual climate control
- In-house telephone
- Large private bathroom featuring full shower with glass door, hairdryer, and premium bath amenities
- Nightly turn-down service
- Soft & firm pillows
- Writing desk
- Bathrobes & slippers
- Choice of bed configuration (two twins or one king)
- Easy under-bed luggage storage
- Floor-to-ceiling sliding-glass door
- In-room safe
- Mini-bar with complimentary local beer, soft drinks & bottled water
- Spacious closets with shelves for ample storage
- Wall-to-Wall Panoramic window measuring 14-feet wide that opens to transform the living space into a large Open-Air Balcony

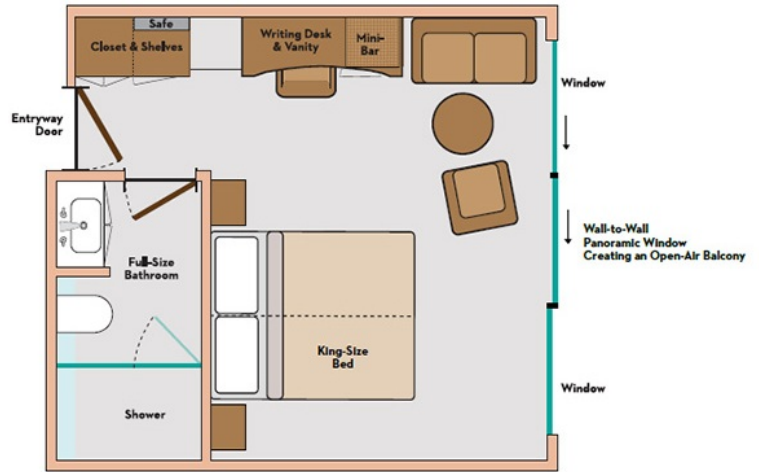

Ship Amenities:

- Open-air deck with shade & premium chairs
- Complimentary Wi-Fi access in the lounges.
- Spa treatment room
- Fitness Center and Library with games
- Audio headsets for all shore excursions
- Friendly, English-speaking crew
- Sightseeing with Certified Local Guides
- Profession Cruise Director
- Onboard movie nights
- Spacious, open seating restaurant
- Air-conditioned Panorama Lounge
- Bar serving premium spirits & complimentary coffee, tea, soft drinks, and local beer/spirits throughout the day

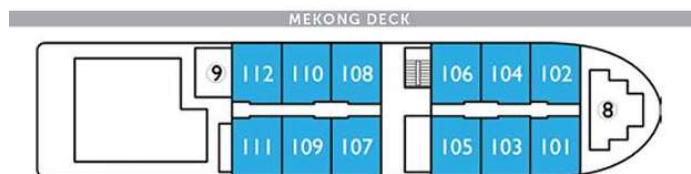
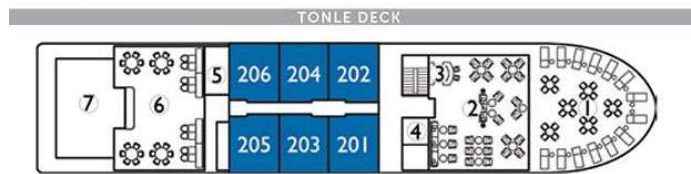
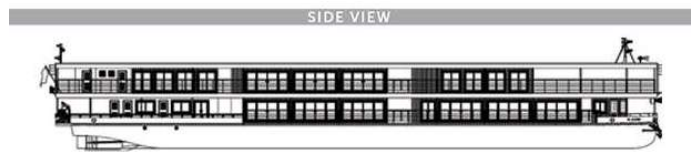

- | | | |
|-------------------------|----------------|------------|
| 1) Open-air observation | 4) Reception | 7) Galley |
| 2) Panorama Lounge | 5) Spa | 8) Bridge |
| 3) Bar | 6) Dining Room | 9) Fitness |